



Branksome Road, Brixton, SW2

1 bedroom flat to let

£385 Per Week

Furnished

Property Details

We are proud to offer this stunning Victorian conversation top floor flat. The property benefits from gorgeous period features and a large double bedroom as well as its own private roof terrace perfect for the summer months, there is also a wonderful open plan kitchen reception area. The flat is located on a popular residential street close to all that Brixton high street has to offer including shops, restaurants and Brixton tube station which gives you access to the Victoria line straight into the city.

Features

- Roof terrace
- Victorian
- Close to transport links
- Top floor
- Close to Brixton station
- Close to Brixton high street
- Open plan kitchen / living

Council tax band C EPC rating E (52)

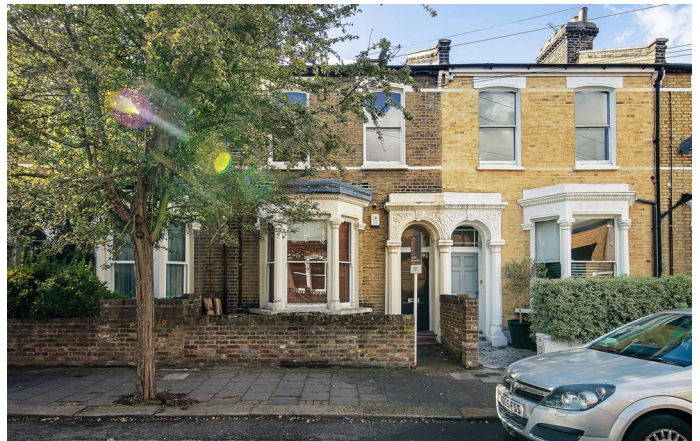

Branksome Road, Brixton, SW2

Branksome Road

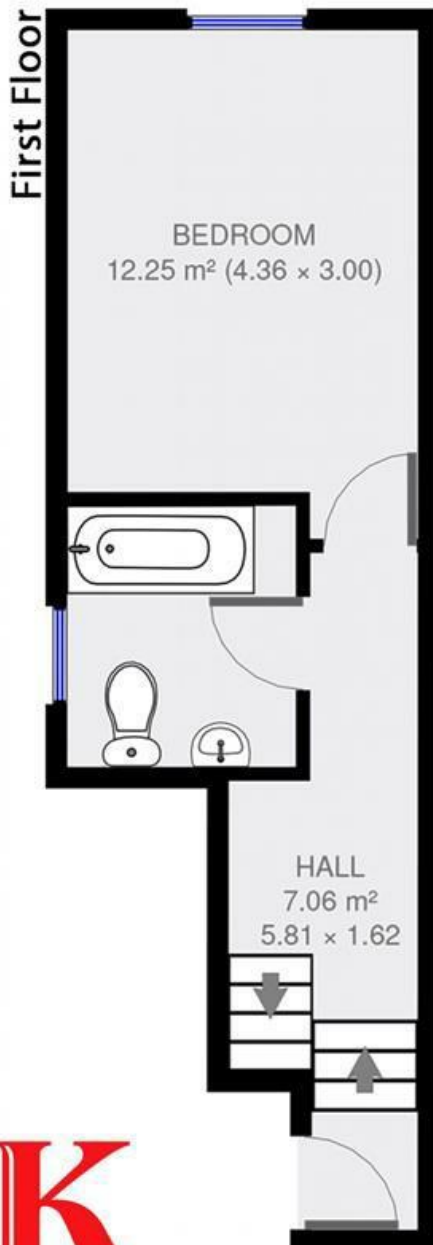

1 bed Flat.

Approx internal area:

582 sqft 54 sqm

While we do try our very best, floor plans are produced as a guide only and we take no responsibility for the precise accuracy with which any property is represented

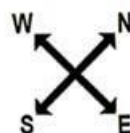

Branksome Road, Brixton, SW2

